

SHEAR LEGS / TRIPODS

CT3

Instruction manual

UK



(optional hoist)

To ensure the constant improvement of its products, HUCHEZ reserves the right to change the equipment as described below and, in this case, to supply products which differ from the illustrations in this instruction manual.

All rights reserved

Contents

1. General warning	p. 3
2. Brief presentation of appliances	p. 3
3. Handling - Storage	p. 5
4. Use, assembly and commissioning	p. 5
5. Maintenance	p. 7
6. Prohibitions for use	p. 7
7. Statutory, compulsory checks by the user	p. 8
8. Putting out of operation	p. 8
9. Specimens declaration of conformity	p. 8
10. Annexes	p. 9

1 – General notice

Tripods delivered on their own are considered Partly Completed Machinery in accordance with European Regulations. Their design and production fulfil the applicable requirements of the Machinery Directive 2006/42/EC, with the following exceptions:

- These tripods may not be commissioned until the tripod + hoist (or winch) assembly has been declared compliant with the pertinent provisions of the above Directive.
- It is particularly advisable to check their adequate stability and fixing to the floor.

However, gins supplied with manual or electric lifting devices are considered machines in compliance with European regulations and, in particular, with the Machinery Directive 2006/42/EC.

- Before using this tripod, with safety of use of the equipment and efficiency in mind, it is vital for you to become familiar with this instruction manual and to comply with all the recommendations.
- This instruction manual must be kept available to all operators.
- The tripods equipped with a lifting appliance (hoist) are designed to carry out lifting operations in a working area specified. Please make sure the operator is qualified to carry out the operation in the conditions laid down in this manual in order to respect the safety of persons and the environment.
- Never use this tripod with a load exceeding the maximum working load specified.
- The tripods may not, under any circumstance, be used to lift staff.
- Before each use, the operator shall check the clearing of the working area, correct condition of the lifting appliance, its rope or chain, hook, marking, as well as its stability.
- The manufacturer declines all responsibility for consequences due to the use or installation of appliances not provided in this manual, together with the consequences of dismantling, alterations or replacements or original parts with parts or components of other sources without its written agreement.

2 - Presentation of appliances

5 capacities available in the range: from 250 to 3,000 kg.

- Aluminium legs individually adjustable in 100 mm steps (250 kg) or 160 mm steps (other models) and locked by self-locking pins.
- Each leg has a handle at its lower part and an articulated foot with :
 - 2 positions (on 500-1000 kg): a flat side for hard ground and a spade-shaped end for soft ground.
 - 3 positions (on 250 kg): serrated shoe (slippery surface), a flat side for hard ground and a spade-shaped end for soft ground.
- Steel head (on 250 kg) or high-strength cast aluminium head (on 500 – 1000 kg) with multiple anchor points for fitting a pulley, a second hook for a tackle, a chain hoist....
- Legs hold together by 3 safety straps each fitted with a carabiner, for models from 500 kg.
- Light and compact when retracted.

2.2. Dimensions :

Capacity (kg)	Height under tripod head (mini. – maxi.)(m)	Length when retracted (m)	Weight (kg)
250	1,50 – 2,00	1,56	25
500	1,90 – 3,30	2,30	45
500	2,80 – 4,20	3,30	55
1000	1,90 – 3,30	2,30	45
2000	2,80 – 4,20	3,30	120
3000	2,80 – 4,20	3,30	120

2.2.1. CT3 250 kg - 2 meters

The three legs are inscribed in a circle of 1.30 to 1.60 m diameter depending on the height deployed.

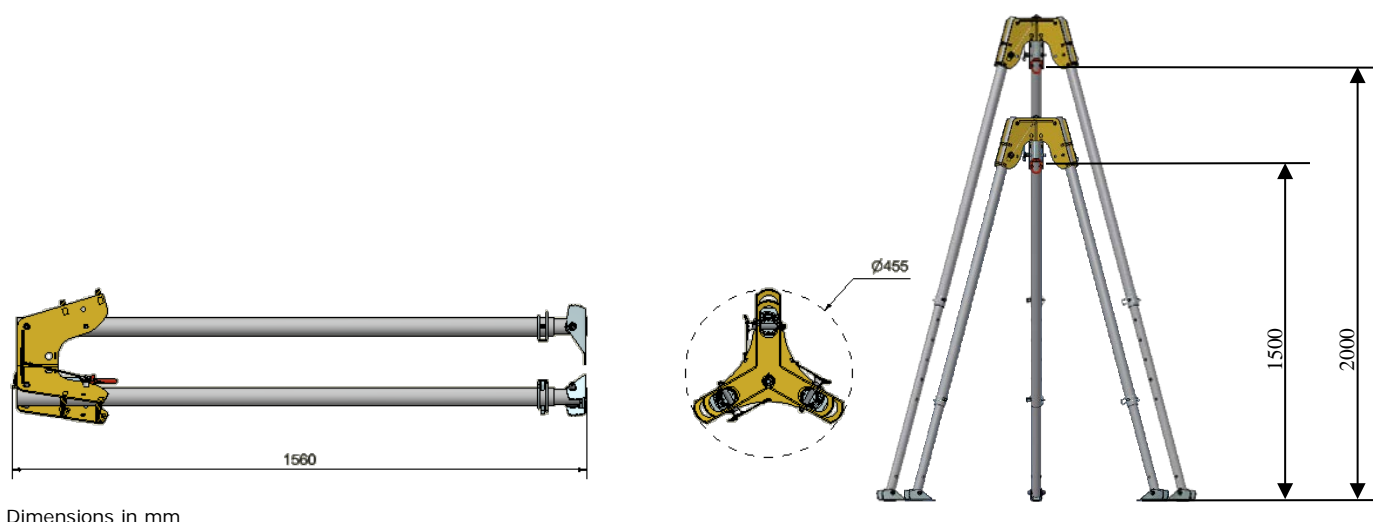

Dimensions in mm

2.2.1. CT3 500 kg and CT3 1000 kg - 3 meters

The feet are inscribed in a circle of 2 m to the 4th hole and 2.30 m beyond.

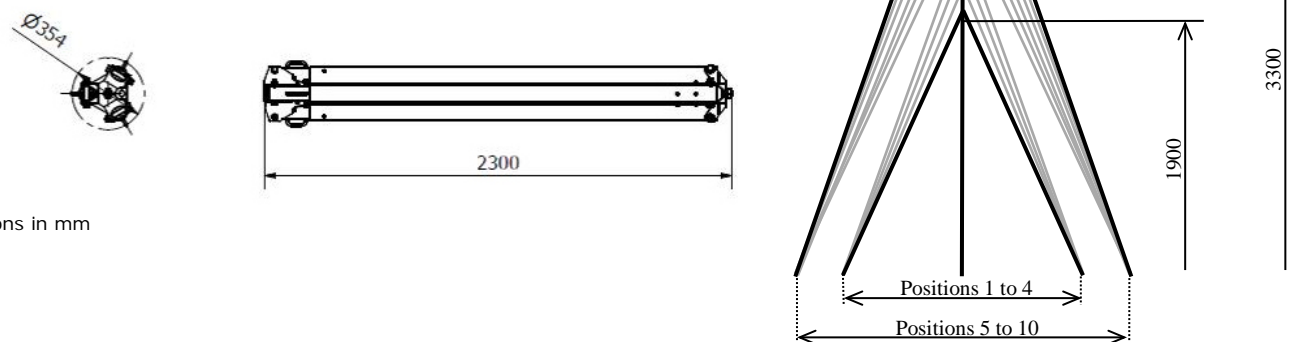

Dimensions in mm

2.2.2. CT3 500 kg, CT3 2000 kg and CT3 3000 kg - 4 meters

The feet are inscribed in a circle of 2.90 m to the 4th hole and 3.45 m beyond.

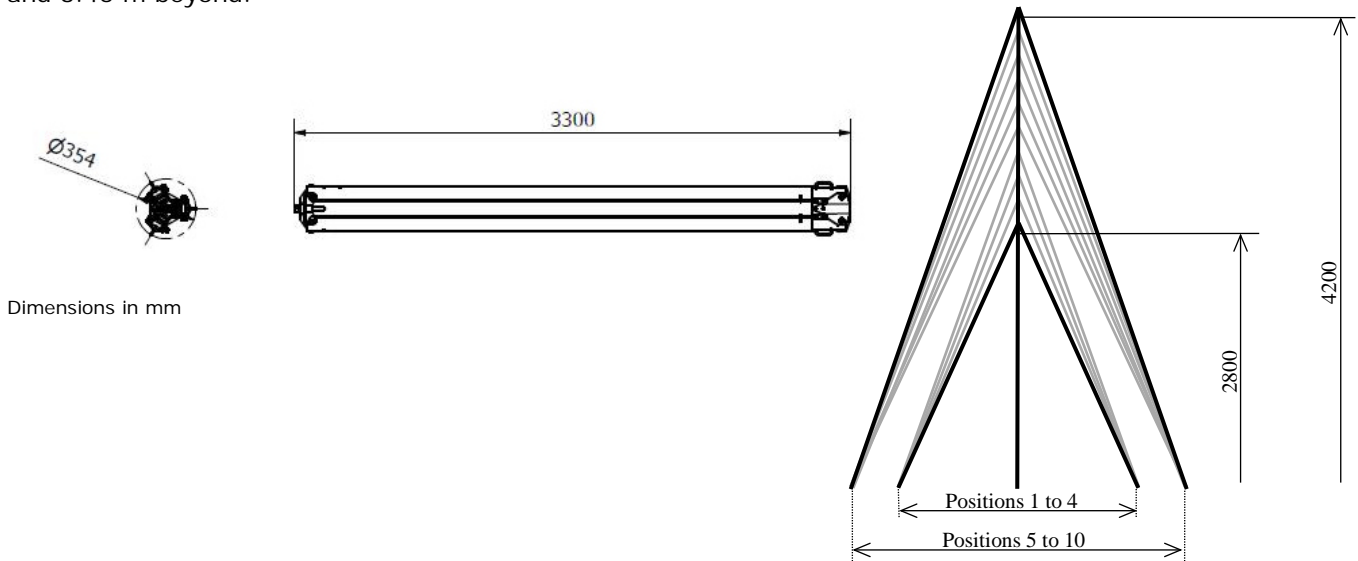

Dimensions in mm

2.3. Operation

Telescopic system and the adjustability of feet enable tripods to be easily adapted to all kinds of sites for use in optimum conditions. The legs are held together by 3 independent safety straps (models from 500 kg).

3 – Handling - Storage

Made of aluminium, tripods are light and easily handled or stored. It is recommended to store away from the elements.

4 – Use, assembly and commissioning

- Ensure of the quality of the ground
- Draw up the appliance by checking the levelling
- Verify that the 3 feet make a circle :
 - From \varnothing 1.30 to 1.60 m depending on the height deployed (CT3 250 kg)
 - From \varnothing 2 to 2.30 m depending on the height deployed (CT3 500 – 3 m and CT3 1000 kg – 3 m)
 - From \varnothing 2.90 to 3.45 m depending on the height deployed (CT3 500 – 4 m, CT3 2000 kg – 4 m and CT3 3000 kg – 4 m)
- Ensure the connection of the feet by the 3 independent straps (models from 500 kg).

There are two lengths of straps depending on the model:

- . a short version (length 2 m) for CT3 500 kg- 3 m and CT3,1000 kg models,
- . a long version (length 3 m) for CT3 500 kg - 4 m and CT3 2000/3000 kg models.

Each of the three straps comprises:

. on one side a loop placed around the aluminum tube.



. on the other side, a hook and a another loop called intermediate.

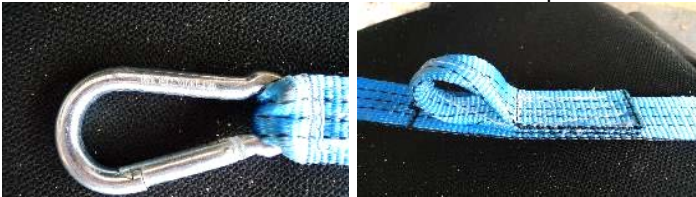

There are two positions for the adjustment of the straps according to the state of deployment.
So :

- When the tripod is expanded to the 4th hole of the aluminum tubes, it is necessary to attach the strap in position "short" that is to say, the strap must pass through the handle in the bottom of the tube and hook the carabiner on the intermediate loop of the strap:

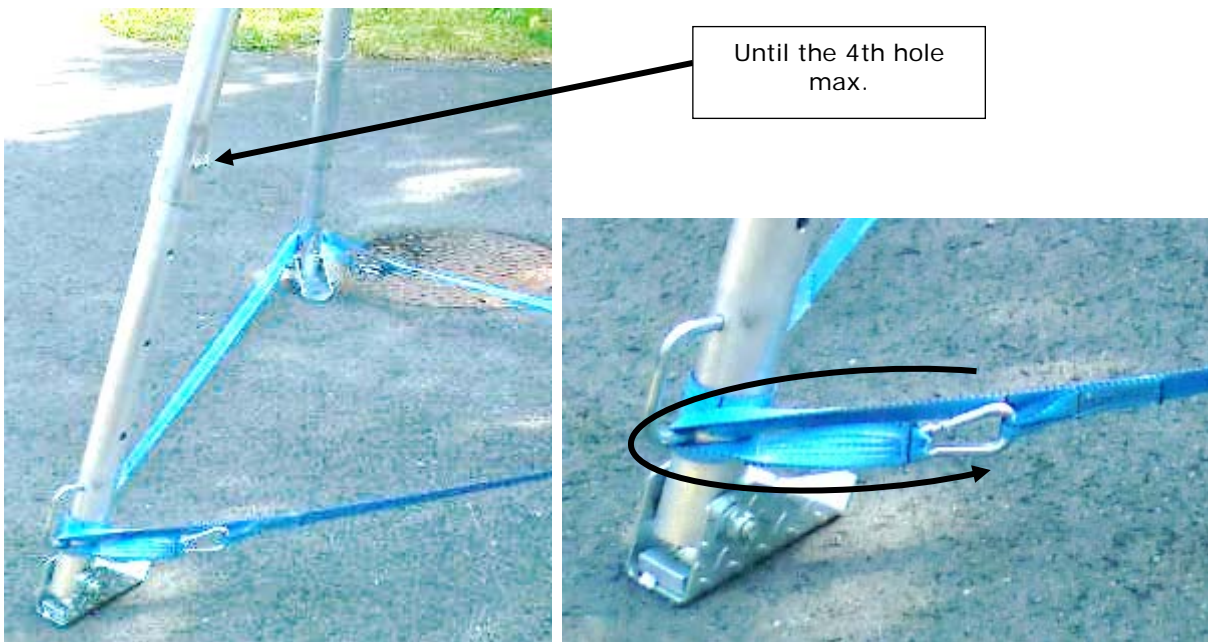

- When the tripod is deployed beyond the 4th hole, directly attach the carabiner on the handle of aluminum tube:



Beyond the 4th hole



- Last, hang the hoist at the point of anchoring of the head

5 – Maintenance

Check the feet fixing and the anchor head regularly, and also the self-locking pins.

Also check the state of the lifting appliance according to the specifications in the instruction manual and in particular, the chain or cable, the hook and the brake.

6 – Prohibitions for use

Before any use, make sure there is no risk of overloading due to: adherence to floor, suction, jamming, etc.

You are be warned against any of the following improper uses or handling operations:

It is prohibited to:

- Lift loads exceeding the rated load specified on the plate of the appliance;
- Pull sideways;
- Swing the load;
- Use the appliance to lift staff;
- Go under the load;
- Use hooks without catches, not suitable for the loads specified on the appliance or in bad condition;
- Insert objects into the moving parts;
- Take action on appliances under load;
- Let down the load on free fall;
- Use the rope or the chain of the appliance as a sling;
- Use the appliances for operations different from those they are designed for;
- Use parts or components different from the manufacturer's original parts or components;
- Reeve by positioning the fixed point on the lifting appliance.

7 – Statutory, compulsory checks by the user

This appliance has been subjected to the following tests in the factory:

- dynamic proof test at coefficient 1.1
- static proof test:
- at coefficient 1.5 for appliances moved by human strength
- at coefficient 1.25 for the others

A periodic maintenance check is required at least once a year.

The user must keep a safety register R.233.11).

In compliance with the regulations, the user must set up an inspection book where all the actions and inspections conducted on the appliance shall be recorded (FEM rule 9755).

8 – Putting out of operation

When the equipment is in a state of decay likely to create risks, the user is obliged to do away with this material i.e.: put it out of operation, dismantle it if required.

9 –Specimens declaration of conformity



DECLARATION OF CONFORMITY

F03.39 - UK Tripod
CT3 - CT4



We hereby declare that the design and manufacture of the machinery referred to below comply with the relevant requirements of Directive 2006/42/EC on Machinery. The machinery's technical file has been put together by the signatory of this declaration. This declaration shall become null and void in the event it is changed or if any item is added without our prior consent. Moreover, this declaration shall become null and void if the machinery is not used in accordance with its instructions for use and if it is not inspected regularly.

Type of device: Telescopic Tripod

Model:

Capacity:

Serial n°:

Function: Hoisting equipment

Quality assurance: ISO 9001 (certificate registration n°: FQA 9911492)

Equipment delivered:

☐ with lifting equipment: ☐ hoist ☐ Manual chain hoist ☐ Electric

☐ winch ☐ Manual ☐ Electric

Capacity:

Serial N°:

☐ with cable ☐ without hook

☐ without cable ☐ without hook

Important: (these items must comply strictly with the specifications indicated on the manufacturer's plate affixed to the winch and the instructions for use, and they must be supplied by professionals specialized in their use.

and with instructions for use.

Issued in Ferrières on:

Antoine HUCHEZ,
President

www.huchez.fr

HUCHEZ S.A.S.
Rég. en France
SIREN 525 149 149

Tel: +33 (0)3 44 51 11 33
Fax: +33 (0)3 44 51 11 33
Email: contact@huchez.fr

S.A.S. with a capital of 4500,000
Rég. en France
SIREN 525 149 149
VAT FR 82 528 020 482





DECLARATION OF CONFORMITY

F03.36.1 - UK Bare CT3 Tripod



PARTLY COMPLETED MACHINERY

We hereby declare that the tripod (partly completed machinery) designated below complies in terms of its design and manufacture with the pertinent requirements of the Machinery Directive 2006/42/EC, except with the following:

- This tripod may not be commissioned until the tripod + hoist (or winch) assembly has been declared compliant with the pertinent provisions of this Directive, when applicable.
- It is particularly advisable to check its adequate stability and fixing to the floor.

Device type: ☐ Telescopic tripod

Model: CT 3

Force:

No:

Final function: Equipment lifting

Quality assurance: ISO 9001 (certificate registration no.: FQA 9911492)

Equipment delivered:

☐ without lifting device (hoist or winch)

with user instructions.

The pertinent technical documentation is drawn up in accordance with Appendix VII-8. We undertake to send, following a duly justified request from the national authorities, the pertinent information concerning the telescopic tripod (partly completed machinery). This commitment will not, in any case, be prejudicial to our intellectual property rights over this device or any other device belonging to the same range. This declaration will be declared null and void in the event of an alteration or the addition of any elements not having previously received our approval. Moreover, this declaration will be declared null and void if the machine is not used in accordance with the instructions of its manual and if it does not undergo regular testing.

In Ferrières, on:

Antoine HUCHEZ,
CEO

www.huchez.fr

HUCHEZ S.A.S.
Rég. en France
SIREN 525 149 149

Tel: +33 (0)3 44 51 11 33
Fax: +33 (0)3 44 51 11 33
Email: contact@huchez.fr

S.A.S. with a capital of 4500,000
Rég. en France
SIREN 525 149 149
VAT FR 82 528 020 482



10 – Annexes

A – If hardware supplied with hoist and winch

A.1 Manual of the hoist

A.2 Manual of the winch

B –Part references

C – Maintenance booklet

A – If hardware supplied with hoist and winch

A.1 Manual of the hoist

Enclosed.

A.2 Manual of the winch

Enclosed.

B – Part references

Bill of materials - CT3 250 kg

Article	Qty	Part number	Description	Article	Qty	Part number	Description
1	3	13014	Nut H FR M8	14	3	24431	Upper tube 250
2	3	13020	Nut H FR M10	15	3	24432	Lower tube 250
3	1	13110	Pin MECA 4x30-A	16	3	24433	Welded foot
4	3	13181	Screw CHC M8x80	17	3	24434	Rubber pad
5	6	13210	Washer M8	18	3	24435	Head brace
6	6	13306	Washer M10	19	3	24436	Foot brace
7	3	13451	Wire lg 200	20	1	24437	Drilled ring EL12R
8	1	13453	Clip pin Ø4.5	21	1	24438	Ring brace
9	3	13454	Spindle lug Ø12x70	22	1	24439	Washer ep 8
10	3	13455	Spring washer 40x16.3x1.5	23	1	24440	Drilled Nut M14
11	3	13456	Clip pin Ø12x65	24	3	24442	Centering ring
12	3	13555	Screw CHC M10x70	25	3	24443	Centering plug
13	1	24430	Head 250				

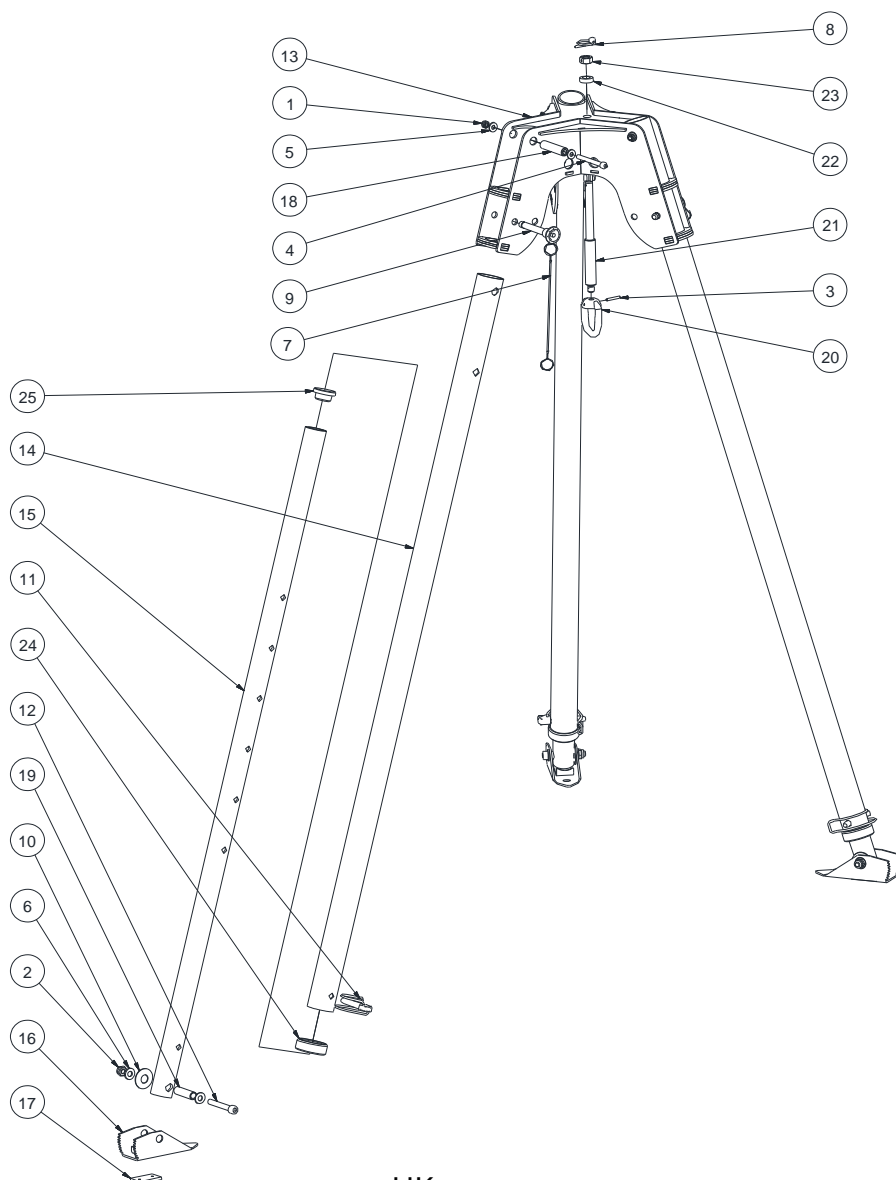

Bill of materials - CT3 500-1000 kg

Article	Qty	Part number	Description
1	3	13212	Washer M12
2	6	13214	Washer M16
3	6	13216	Washer M20
4	1	13290	Nut NF E 24032 M27
5	1	13310	Washer M27
6	3	13415	Screw H M16x110
7	3	13433	Nut H FR M12
8	3	13485	Nut H FR M16
9	3	13597	Nut H FR M20
10	3	1767	Safety pin

Article	Qty	Part number	Description
11	1	20601	Head
12	3	20602	Upper foot
13	3	20603	Lower foot
14	3	20604	Articulated foot
15	3	20605	Articulated foot spacer
16	1	20613	Ring C3127C2
17	3	20614	Screw H M20x130
18	3	20684	Retention strap ring
19	3	24423	Strap 2 m (CT3 500 – 3 m)
	3	24059	Strap 4 m (CT3 500 – 4 m et CT3 1000)

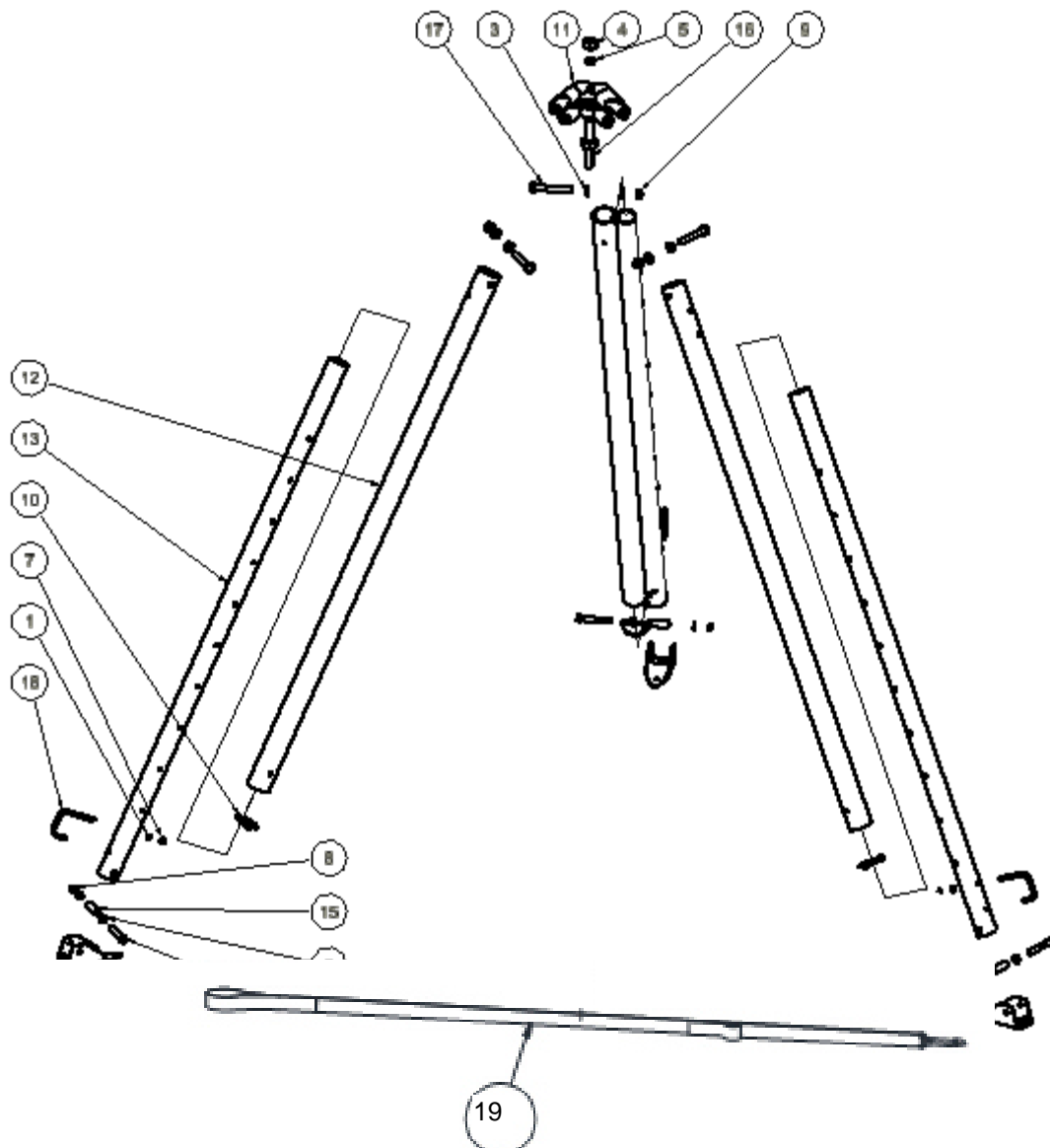

Bill of materials CT3 2000-3000 kg

Article	Qty	Part number	Description
1	6	13026	Nut NF E 24032 M20
2	3	13092	Screw TH ISO 4014 M12x150
3	12	13216	Washer NF E 25514 M20
4	1	13217	Washer NF E 25514 M24
5	1	13289	Nut NF E 24032 M24
6	3	20672	Tube foot
7	3	20673	Upper foot

Article	Qty	Part number	Description
8	3	20674	Articulated foot
9	3	20675	Pin
10	1	20676	Head
11	3	20678	Articulated foot spacer
12	3	20680	Screw TH ISO 4014 M20x180
13	1	20683	Ring C3118 D24
14	3	24059	Strap 3 m

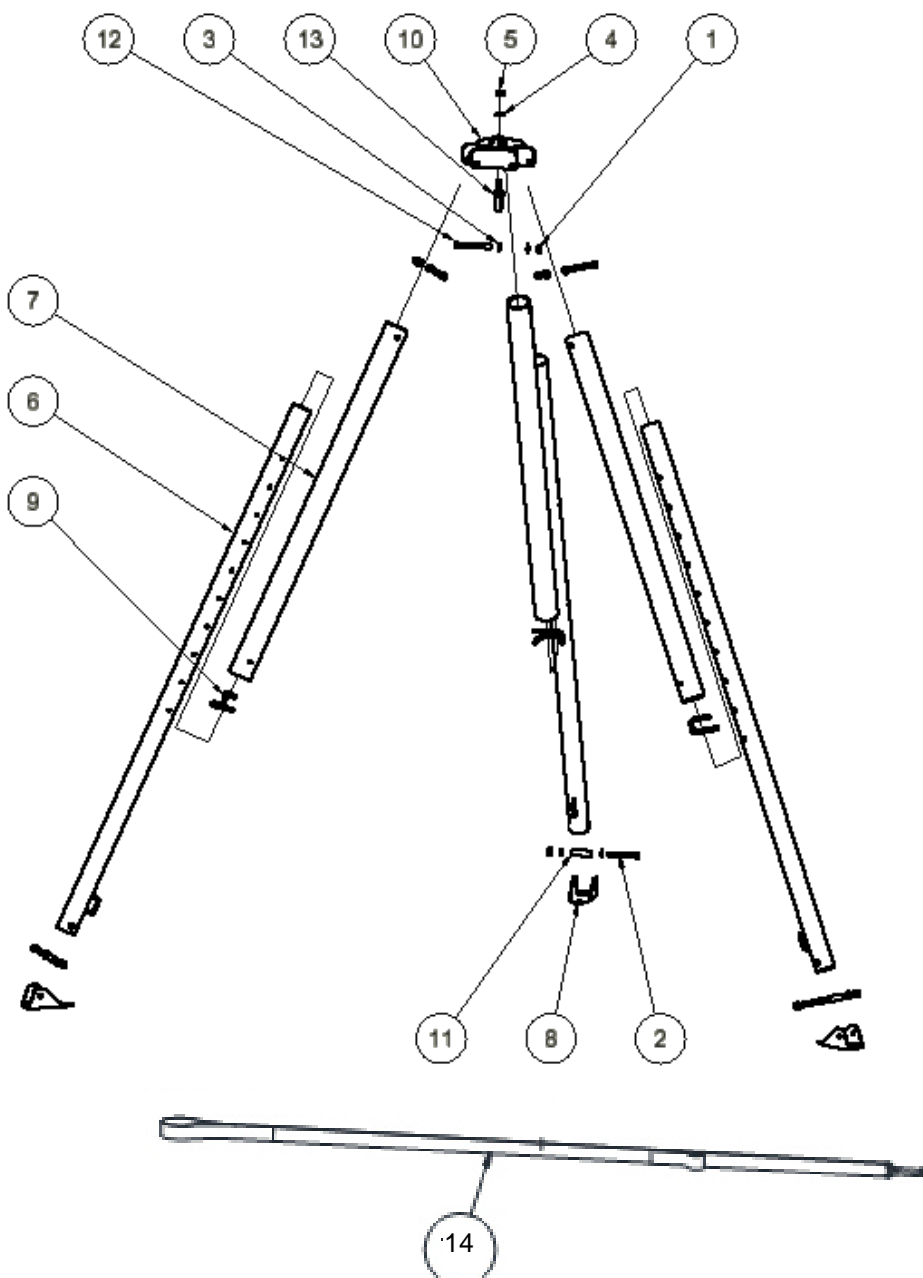

C — Maintenance booklet.



The English version of the maintenance booklet for our lifting winches can be downloaded from our website **www.huchez.fr/uk** under the heading "After sales services".

Date	Person In charge		Nature of the operation	References of replaced parts	Frequency if appropriate	Signature

Huchez® 2012